

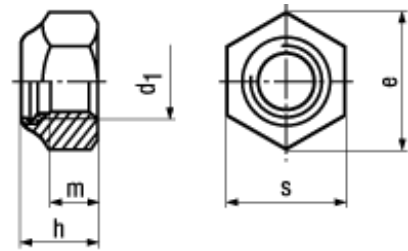

DIN 985

Standard withdrawn

8



BN 163

Prevailing torque type hex lock nuts

thin type, metric fine thread, with polyamide insert

Steel 8

zinc plated blue

- ~UNI 7474

M10; M12; M14; M22: wrench size according to ISO on request

Article#	d ₁	e min.	h max.	m	s
1095080	M8x1	14,38	8	5,5	13
1343211	M10x1	18,90	10	6,5	17
1095099	M10x1,25	18,90	10	6,5	17
1807560	M12x1	21,10	12	8	19
1095102	M12x1,25	21,10	12	8	19
1141589	M12x1,5	21,10	12	8	19
1141597	M14x1,5	24,49	14	9,5	22
1095110	M16x1,5	26,75	16	10,5	24
1807595	M18x1,5	29,56	18,5	13	27
1120174	M20x1,5	32,95	20	14	30
1807579	M22x1,5	35,03	22	15	32
1416243	M24x2	39,55	24	15	36
3091600	M30x2	50,85	30	19	46
3091601	M36x3	60,79	36	25	55