

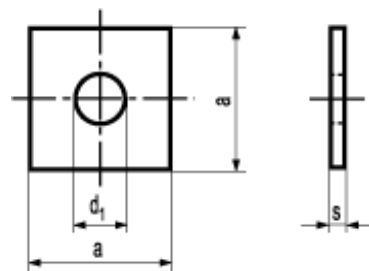

DIN 436



BN 33035

Čtyřhranné podložky

pro dřevěné konstrukce

Nerezová ocel A4

Article#		d ₁ min.	s	a max.
5817000	M10	11	3	30
5817010	M12	13,5	4	40
5817020	M16	17,5	5	50
5817030	M20	22	5	60
5817040	M22	24	6	70
5817050	M24	26	6	80