

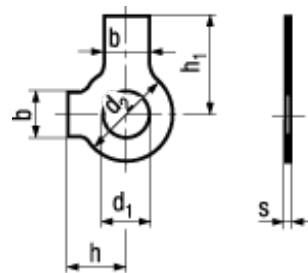

DIN 463

Norma stažena



BN 845

Pojistné podložky

se 2 jazýčky

Ocel

pozinkováno modře

- ~UNI 1747

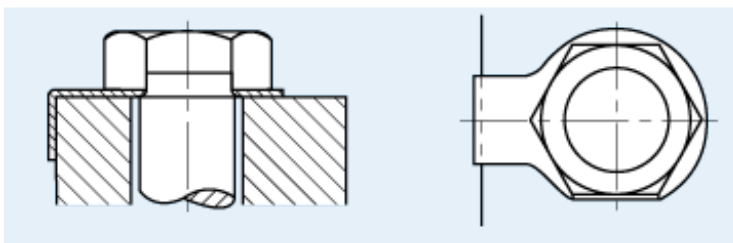

Article#		d ₁	d ₂	b	h	h ₁	s
1294458	M4	4,3	9	5	6,5	14	0,38
1294466	M5	5,3	10	6	8	16	0,5
1294474	M6	6,4	12,5	7	9	18	0,5
1294482	M8	8,4	17	8	11	20	0,75
1294490	M10	10,5	21	10	13	22	0,75
1294504	M12	13	24	12	15	28	1
1294512	M14	15	28	12	16	28	1
1294520	M16	17	30	15	18	32	1
1294547	M20	21	37	18	21	36	1
1294555	M22	23	39	20	23	42	1
1294563	M24	25	44	20	25	42	1
1294598	M27	28	50	23	29	48	1,6
1294628	M30	31	56	26	32	52	1,6
1294644	M33	34	60	28	34	56	1,6
1294660	M36	37	66	30	38	60	1,6
1294687	M39	40	72	32	41	64	1,6